

DIAL INDICATORS (BASIC TYPE)

- Meet DIN878
- Jeweled bearing
- Supplied with limit hands and bezel clamp
- Packed in carton box
- Optional accessory: backs (page 129~130), contact points (page 126~128)

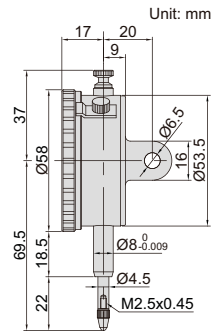

2301-10



Code	Range	Graduation	Accuracy	Hysteresis	Range/rev	Dial reading	Remark
2301-10F*	10mm	0.01mm	17 μ m	3 μ m	1mm	0-100	flat back
2301-10*	10mm	0.01mm	17 μ m	3 μ m	1mm	0-100	lug back with spare flat back

*Supplied with manufacturer inspection certificate traceable to NIST USA